

Arcs Editing 1M Exercise

Metric Measure

Level 1 Module 15



For more exercises, go to <http://www.micro-press.com/Resources.html>

If you intend to use this copyright document for teaching or commercial purposes, please attribute the source and add a live link to our site.

This exercise is best done after completing Module 15 of our MicroStation 2D Level 1 Training Manual.

Having completed the ARCS 1 drawing, the designers decide that changes must be made to the plate (complete the ARCS 1 exercise first!). They have indicated the new dimensions for the design in the drawing below. (Do not draw the dimensions.)

Do the following:

Make all necessary dimensional changes to the your Anchor Plate drawing using appropriate editing tools.

Change all line styles (other than Continuous) to Custom line styles.

Create Named Levels and change the attributes of all elements as shown in the table at the right.

Level	Color	Weight
Object	Red	1
Text	Blue	0
Dim	Magenta	0
Centerline	Yellow	0

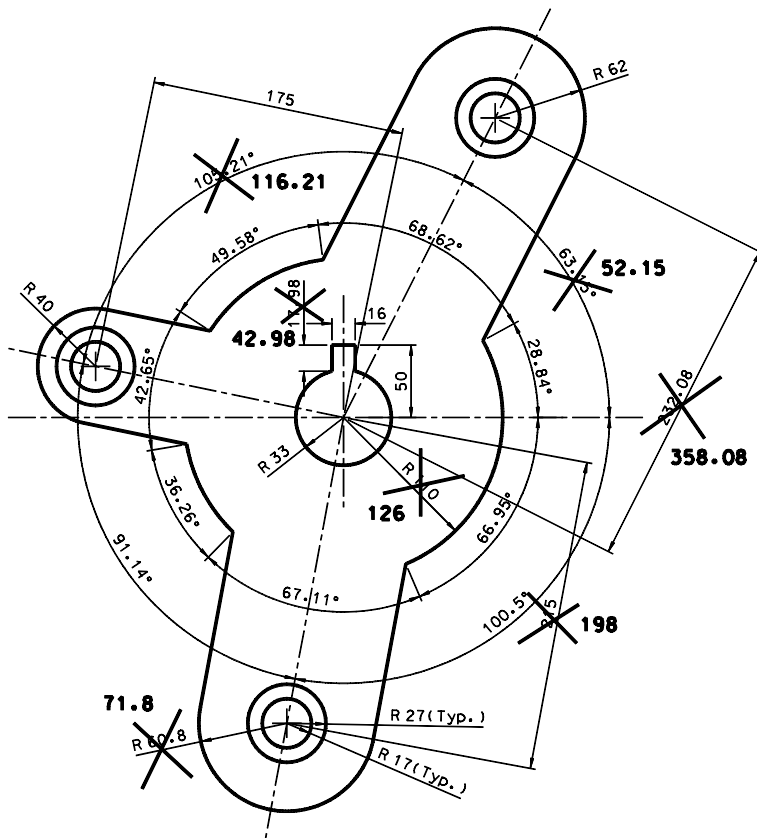

FRONT VIEW

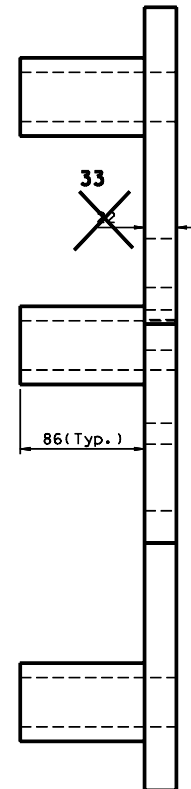

RIGHT-SIDE VIEW